

RESOLUTION NO. 2537

A RESOLUTION of the Port Commission of the Port of Seattle, Washington, amending Unit 20 of the Comprehensive Scheme of Harbor Improvements and Industrial Development for the Lower Duwamish Industrial Development District authorizing the acquisition of specific real property situated within Unit 20 of said Comprehensive Scheme.

WHEREAS, the voters of King County, pursuant to the provisions of enabling legislation adopted by the Legislature of the State of Washington, Chapter 92, Laws of 1911, RCW 53.04.010, authorized and approved at a special election held in King County on the 5th day of September, 1911, the formation of a Port District coextensive with King County to be known as the Port of Seattle; and

WHEREAS, the Port of Seattle was thereupon established as a Port District and has since been and now is a duly authorized and acting Port District of the State of Washington; and

WHEREAS, the Legislature of the State of Washington by Chapter 73, Laws of 1955, RCW Chapter 53.25 authorized the Port Commission to create industrial development districts within the Port District and define the boundaries thereof and to establish comprehensive schemes of harbor improvements and industrial developments for such district; and

WHEREAS, the Lower Duwamish Industrial Development District Comprehensive Scheme of Harbor Improvements and Industrial Developments was heretofore adopted by the Port Commission of the Port on September 14, 1962, by Resolution No. 2111, which said industrial development district scheme has been subsequently amended in the manner provided by law; and

WHEREAS, a public hearing was held on June 21, 1974, of which at least ten (10) days' notice was given by publication in a daily newspaper of general circulation in the Port District as provided by law on the questions of whether or not Unit 20 of the Port's Comprehensive Scheme of Harbor Improvements and Industrial Developments for the Lower Duwamish Industrial Development District should be amended to include additional real property within the Port District along the boundary of the present Industrial Development District; and

WHEREAS, after discussion and consideration of the aforesaid questions at said hearing at which time the Port Commission presented and considered maps, plans, and other data, indicating the property proposed to be added to Unit 20 of the Port's Comprehensive Scheme for the Lower Duwamish Industrial Development District, all of which maps, plans and other data were and now are on file in the Office of the Port Commission; and

WHEREAS, the Port Commission heard from all persons desiring to speak upon the aforesaid questions at said hearing;

NOW, THEREFORE, BE IT RESOLVED by the Port Commission of the Port of Seattle, Washington, as follows:

RESOLVED, that after and pursuant to a public hearing on June 21, 1974, following notice thereof given as required by law; the Port Commission of the Port of Seattle, Washington, does hereby adopt the following amendment to Unit 20 of the Lower Duwamish Industrial Development District Comprehensive Scheme of Harbor Improvements and Industrial Developments.

Section 1. The Commission finds that an enlargement of a portion of Unit 20 of the Lower Duwamish Industrial Development District for marine terminal purposes is a proper and desirable part of the Port's system of Harbor Improvements and Industrial Development in such Port District. Accordingly, the Port of Seattle, Washington, is authorized to acquire by negotiation or by proceedings in eminent domain if necessary, the following described parcel of real property together with any and all improvements thereon.

Description

Lots 1 through 19, Block 4, Lots 1 through 16, Block 7 all in Industrial Addition to the City of Seattle AND;

West Alaska Street from the west boundary of Colorado Avenue to the east boundary of Ohio Avenue AND;

that part of Diagonal and South Oregon Streets from the west boundary of Colorado Avenue to the northerly extension of the east boundary of Ohio Avenue lying south of the following described line:

Beginning at a point on the east line of Ohio Avenue, said point being 30 feet northwesterly of (measured at right angles) the centerline of Diagonal Avenue South; thence northeasterly along a line which is parallel with and 30 feet northwesterly of the centerline of Diagonal Avenue South a distance of 109.30 feet to a point on the north line of South Oregon Street; thence east along said north line 156.97 feet to the intersection of said north line and the west line of Colorado Avenue South.

Section 2. The immediate contemplated purpose of the acquisition of this parcel is to provide additional warehouse space for OCP cargo and other marine and industrially oriented warehousing requirements, particularly as related to Terminal 106 adjoining this property

Adopted by the Port Commission of the Port of Seattle, Washington, at a meeting held this 21st day of June, 1974, and duly authenticated in open session, by the signatures of the Commissioners voting in favor thereof and the seal of the Commission.

(SEAL)

George R. Peterson
Merle D. Bellum
Jack S. Blum
Anthony J. Simonson
Paul H. Sessler
Port Commissioners

ATTEST:

Jack S. Blum
Secretary of the Commission

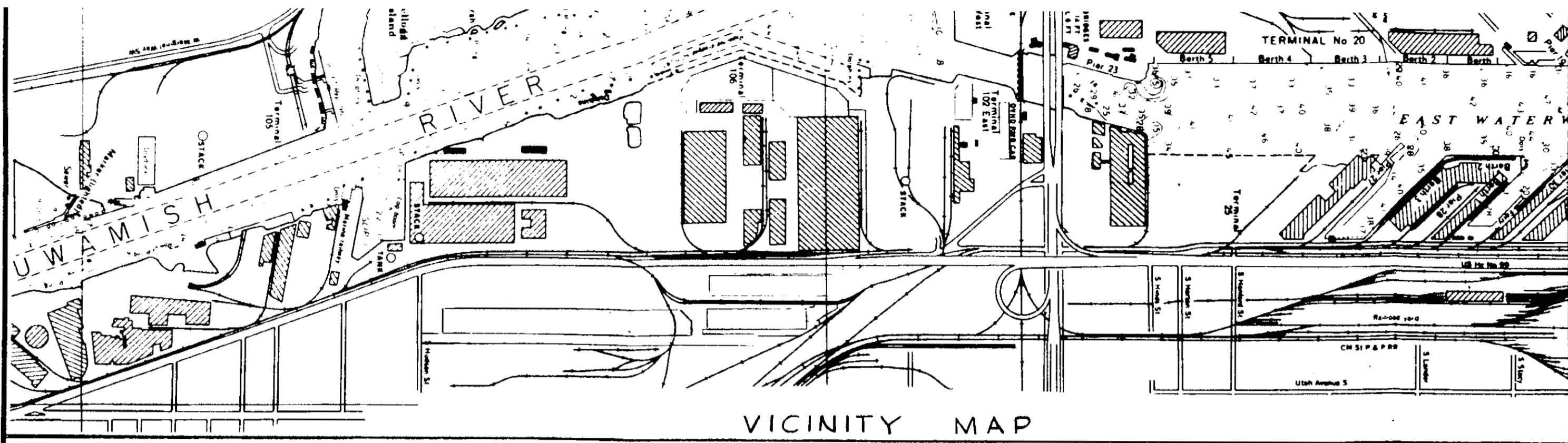

BLK. 380 S.T.L.

(NOT OPEN)



SO. IDAHO ST.

SO. NEVADA S

EAST MARGINAL WAY SOUTH

N 0° 07' 06" W ADD. PLAT

N 0° 00' 00" E S.T.L.

6 INDUSTRIAL

5 ADDITION

PORT OF SEATTLE TERMINAL 106 EAST

BLK. 355 SEATTLE TIDE LANDS

OHIO N 0° 07' 06" W AVENUE SOUTH

HUDSON ST. SOUTH

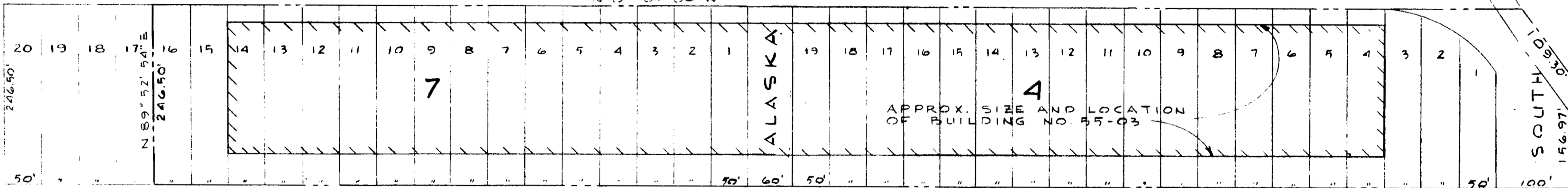

APPROX. SIZE AND LOCATION OF BUILDING NO. 55-03

COLORADO AVENUE SOUTH

8 TO THE CITY OF 3

UTAH AVENUE SOUTH

9 SEATTLE

2

FIRST AVENUE SOUTH

LEGAL DESCRIPTION

Lots 1 through 19, Block 4, Lots 1 through 16, Block 7 all in Industrial Addition to the City of Seattle AND;

West Alaska Street from the west boundary of Colorado Avenue to the east boundary of Ohio Avenue AND;

that part of Diagonal and South Oregon Streets from the west boundary of Colorado Avenue to the northerly extension of the east boundary of Ohio Avenue lying south of the following described line:

Beginning at a point on the east line of Ohio Avenue, said point being 30 feet northwesterly of (measured at right angles) the centerline of Diagonal Avenue South; thence northeasterly along a line which is parallel with and 30 feet northwesterly of the centerline of Diagonal Avenue South a distance of 109.30 feet to a point on the north line of South Oregon Street; thence east along said north line 156.97 feet to the intersection of said north line and the west line of Colorado Avenue South.

CONTAINING APPROX. 468,008 SQ. FT. (10.744 Ac.)

FULL SCALE: 1"=100'

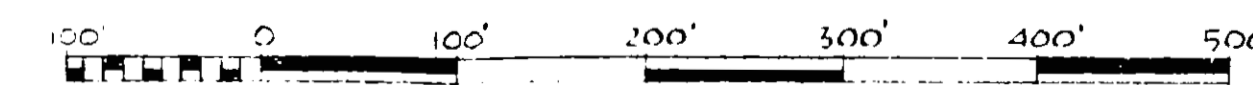

DESIGN ENGINEER

DESIGNER
DRAWN BY
SCALE

REVISIONS

NO.	DATE	BY	DESCRIPTION	APP'D.	NO.	DATE	BY	DESCRIPTION	APP'D.

PORT OF SEATTLE

DESIGN ENGINEER
DESIGNER: FISHER
DRAWN BY: ...
SCALE: NOTED
DATE: JUNE 1974
CHECKED BY: ...

MARINE FACILITIES
L.D.I.D.D. RESOLUTION NO. 2537
AMENDING UNIT NO. 20 OF

WORK ORDER NO.
CONSULTANT'S NO.